

# Two Speed Self-Tailing Winch

# 40.2st

## HARKEN

### Winch Parts and Service Instructions

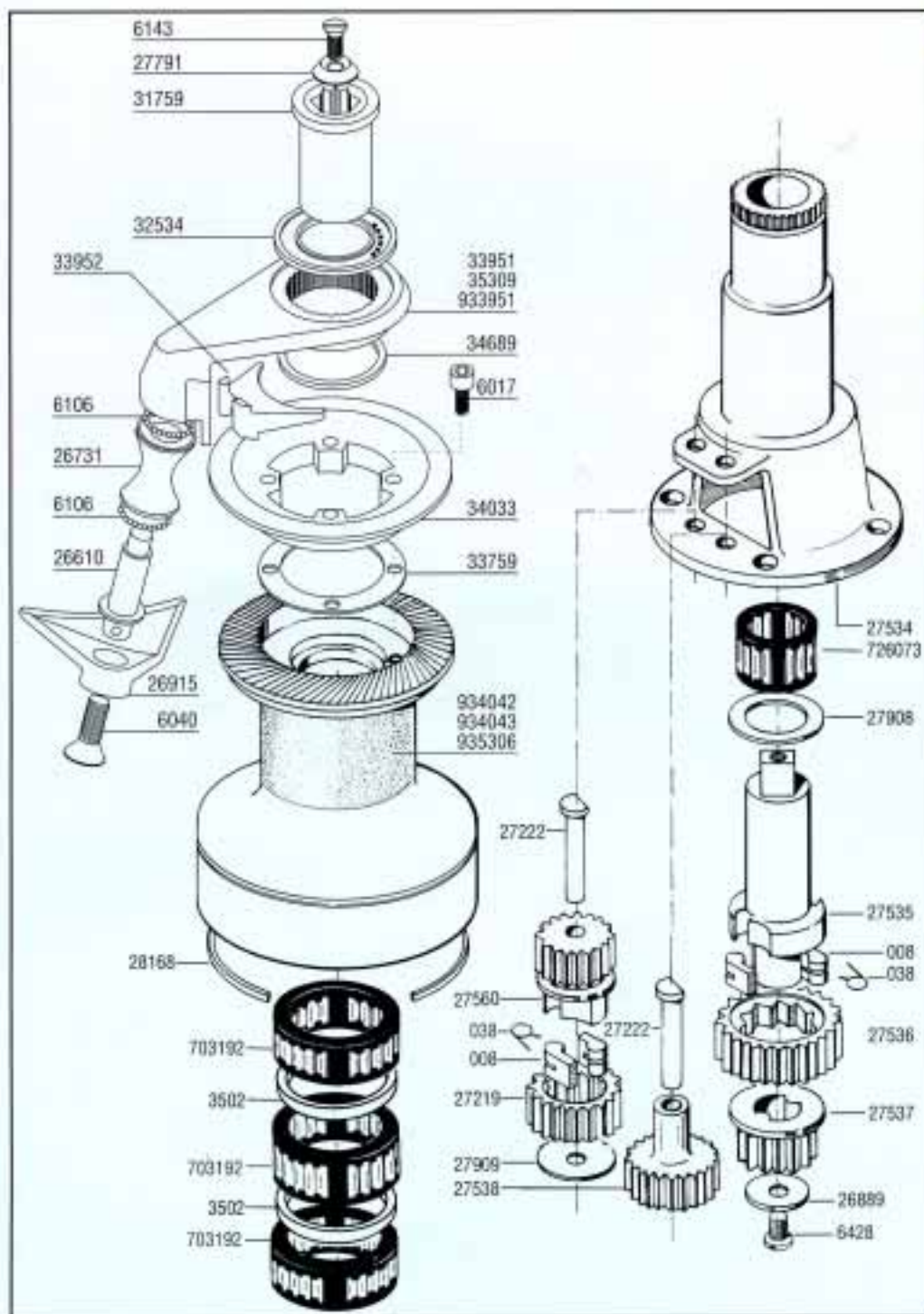

When ordering parts for service, please include a "B" before each number (i.e. B008).

#### Tools Required

- Screwdriver
- Allen Wrench (5mm)
- Plastic Head Hammer or Mallet
- Small Knife
- Brush
- Rags
- Solvent
- Oil
- Grease

#### Parts List

- |        |                              |
|--------|------------------------------|
| 008    | Pawl                         |
| 038    | Pawl Spring                  |
| 3502   | Bearing Spacer               |
| 6017   | Screw                        |
| 6040   | Screw                        |
| 6106   | Ball (32 required)           |
| 6143   | Top Screw                    |
| 6428   | Screw                        |
| 26610  | Roller Shaft                 |
| 26731  | Roller                       |
| 26889  | Cover Plate                  |
| 26915  | Guide Arm                    |
| 27219  | Ratchet Gear                 |
| 27222  | Gear Shaft                   |
| 27534  | Center Stem                  |
| 27535  | Spindle                      |
| 27536  | Ratchet Gear                 |
| 27537  | Gear                         |
| 27538  | Gear                         |
| 27560  | Pawl Gear                    |
| 27791  | Plastic Washer               |
| 27908  | Washer                       |
| 27909  | Cover Plate                  |
| 28168  | Red Line Ring                |
| 31759  | Handle Socket                |
| 32534  | Top Cap                      |
| 33759  | Adjustment Spacer            |
| 33951  | Chrome Stripper Arm          |
| 33952  | Line Peeler                  |
| 34033  | Upper Jaw                    |
| 34689  | Plastic Washer               |
| 35309  | Bronze Stripper Arm          |
| 703192 | Bearing                      |
| 726073 | Bearing                      |
| 933951 | Chrome Stripper Arm Assembly |
| 934042 | Aluminum Drum                |
| 934043 | Chrome Drum                  |
| 935306 | Bronze Drum                  |

#### Suggested Service Kits

- |        |                |
|--------|----------------|
| BK4512 | 10 Pawls 008   |
|        | 10 Springs 038 |
| BK4513 | 100ml Grease   |

### Adjusting Self-Tailer

Self-tailing winches must be adjusted for line size to insure proper operation. If the line slips in the jaws, remove the adjustment spacer 33759 from under the upper jaw 34033. If the winch self-tails properly with the washer in place, do not remove it. The efficiency of the winch will be compromised when using larger lines.

### Positioning Stripper Arm

Loosen top screw  
Remove handle socket  
Lift stripper arm and drum; position as desired

### Opening Winch

Remove top screw  
Lift off drum and stripper arm

### Servicing Winch

Remove pawls and springs - service as below  
Remove bearing, gear shaft and gears  
To reach interior shaft bearing, winch must be removed from deck  
Clean all parts with rags and solvent  
Use a brush to lubricate all moving parts lightly with grease  
Replace pawls and springs and lubricate lightly with oil  
Reassemble and close winch

### Servicing Pawls

Catch spring with knife and hold against pawl  
Lift out pawl  
Clean and check for wear  
Place spring against pawl with straight leg against pawl  
Hold spring closed and slip pawl into pawl socket  
Lubricate pawls using oil

### Fitting on Boat

Make sure mounting surface is flat  
Check sheet entry angle  
Open winch  
Position winch on deck with drive gear where sheet enters winch drum and mark holes  
Remove winch and drill holes  
Mount using five 1/4" (6mm) flat head machine screws  
Apply bedding compound and bolt winch to boat  
Clean excess bedding compound from base drain holes  
Lubricate and reassemble winch

### Adjusting Self-Tailer

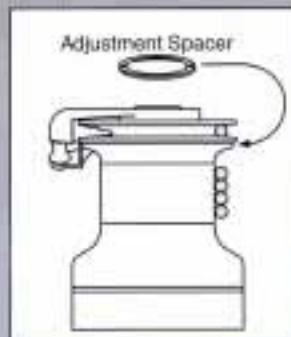

Remove or add adjustment spacer.

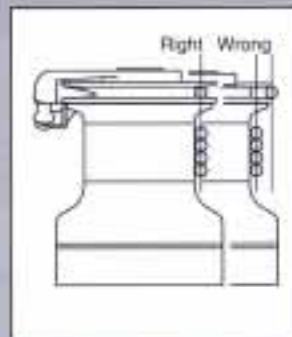

Correct opening: Steel fits completely into jaw and rests against drum.

### Servicing Winch



Clean all parts with solvent



Grease lightly and spread grease evenly. Use a brush.



Attention: Ratchet gear mounted backwards will cause winch to slip.

### Servicing Pawls



Use knife to free captive spring.



Insert spring with straight leg against pawl. Use oil for lubrication.

### Fitting on Boat

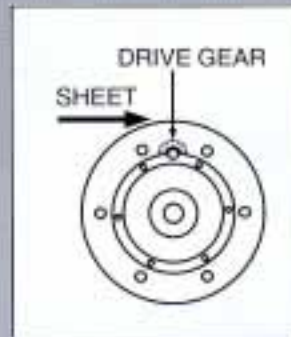

Position drive gear where sheet enters winch drum.



Sheet entry angle must be at least 8°.